

**Ersatzteile – Scheibenventile / Lebensmitteltechnik, Chemietechnik**      Art.Nr.    EUR      Art.Nr.    EUR

**Halteblech für Nahrungsschalter, Handgriff, hinten**

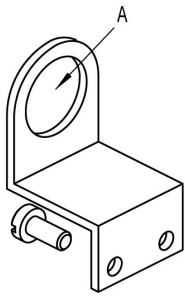

DN	A							AISI304	
25-65 (1"-2,5")	∅12,3							516733	10,30
25-65 (1"-2,5")	∅18,3							514733	10,30
80-100 (3"-4")	∅12,3							516738	13,90
80-100 (3"-4")	∅18,3							514738	13,90
125-200	∅12,3							516741	21,50
125-200	∅18,3							514741	21,50

**Schaltblech fur Nahrungsschalter, Handgriff**

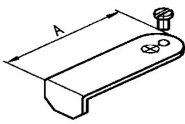

DN	A							AISI304	
25-100 (1"-4")	45							514933	7,80
125-200	55							514941	12,90

**Antrieb Luft-Luft fur Scheibenventil**

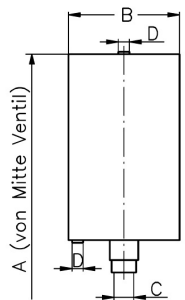

DN	A	B	C	D				AISI304	
25/1"	236	89	9,5	R 1/8"				515233	404,10
32/1,25"	238	89	9,5	R 1/8"				515233	404,10
40/1,5"	241	89	9,5	R 1/8"				515233	404,10
50/2"	247	89	9,5	R 1/8"				515233	404,10
65/2,5"	256	89	9,5	R 1/8"				515233	404,10
3"	263	89	9,5	R 1/8"				515233	404,10
80	263	89	9,5	R 1/8"				515233	404,10
100/4"	273	89	9,5	R 1/8"				515233	404,10
125	332	129	14	R 1/8"				515241	1.085,40
150	347	129	14	R 1/8"				515241	1.085,40
200	385	129	14	R 1/8"				515241	1.085,40

**Antrieb Luft-Feder fur Scheibenventil**

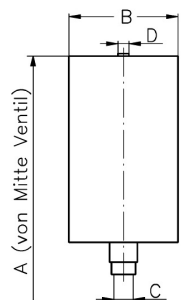

DN	A	B	C	D				AISI304	
25/1"	226	85	9,5	R 1/8"				515333	435,30
32/1,25"	228	85	9,5	R 1/8"				515333	435,30
40/1,5"	231	85	9,5	R 1/8"				515333	435,30
50/2"	237	85	9,5	R 1/8"				515333	435,30
65/2,5"	246	85	9,5	R 1/8"				515333	435,30
3"	253	85	9,5	R 1/8"				515333	435,30
80	253	85	9,5	R 1/8"				515333	435,30
100/4"	263	85	9,5	R 1/8"				515333	435,30